

BLADES FOR PCB SEPARATORS SEP3 & HEKTOR 2

**OLAMEF P/N
for HEKTOR 2
& SEP3**

THICKNESS

**CAB P/N
for HEKTOR 2
& SEP3**

DESCRIPTION



L BLADES STANDARD with L=5mm

| | | | |
|-----------|-------|---------|-------------------------|
| 1060015 | 1.4mm | 8932122 | L BLADE for >1.5mm slot |
| 1060020 | 1.9mm | 8932123 | L BLADE for >2mm slot |
| 106002501 | 2.3mm | 8932141 | L BLADE for >2.4mm slot |
| 1060025 | 2.4mm | 8932124 | L BLADE for >2.5mm slot |
| 1060030 | 2.9mm | 8932125 | L BLADE for >3mm slot |

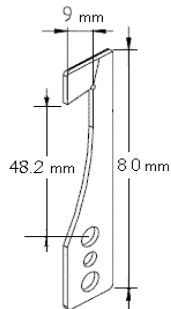

L BLADES REINFORCED with L=9mm (80mm)

| | | | |
|---------|-------|--|-------------------------|
| 1060115 | 1.4mm | | L BLADE for >1.5mm slot |
| 1060120 | 1.9mm | | L BLADE for >2mm slot |
| 1060125 | 2.4mm | | L BLADE for >2.5mm slot |
| 1060130 | 2.9mm | | L BLADE for >3mm slot |

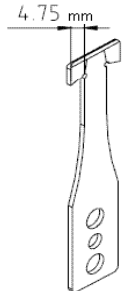

T BLADES STANDARD with LENGTH L=4.75mm

| | | | |
|-----------|-------|---------|-------------------------|
| 1060215 | 1.4mm | 8932137 | T BLADE for >1.5mm slot |
| 1060220 | 1.9mm | 8932138 | T BLADE for >2mm slot |
| 106022501 | 2.3mm | 8932191 | T BLADE for >2.4mm slot |
| 1060225 | 2.4mm | 8932139 | T BLADE for >2.5mm slot |
| 1060230 | 2.9mm | 8932144 | T BLADE for >3mm slot |



L BLADES STANDARD with L=3.5mm

| | | | |
|---------|-------|--|-------------------------|
| 1060315 | 1.4mm | | L BLADE for >1.5mm slot |
| 1060320 | 1.9mm | | L BLADE for >2mm slot |
| 1060325 | 2.4mm | | L BLADE for >2.5mm slot |
| 1060330 | 2.9mm | | L BLADE for >3mm slot |

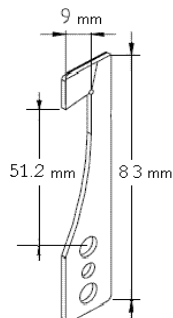

L BLADES REINFORCED with L=9mm TALL (83mm)

| | | | |
|---------|-------|--|-------------------------|
| 1060415 | 1.4mm | | L BLADE for >1.5mm slot |
| 1060420 | 1.9mm | | L BLADE for >2mm slot |
| 1060425 | 2.4mm | | L BLADE for >2.5mm slot |
| 1060430 | 2.9mm | | L BLADE for >3mm slot |